

# Design #1: Native Parking Strip

*Attract wildlife in small spaces with an ornamental grass garden*

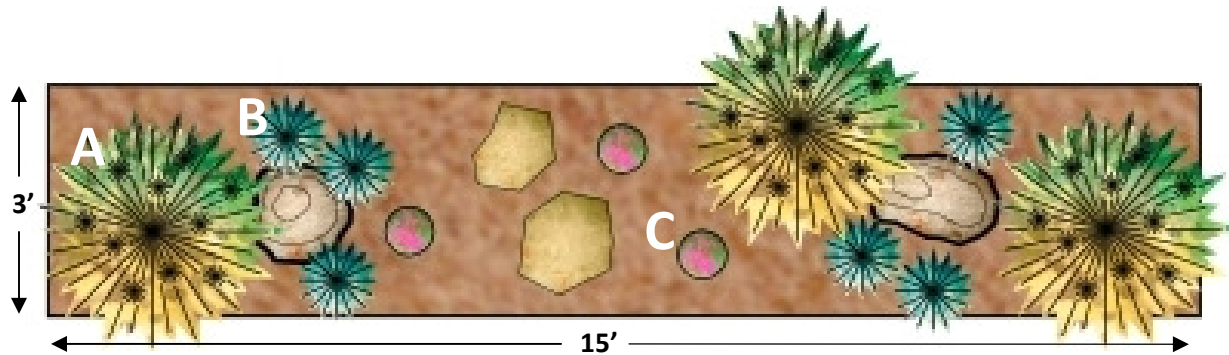

## Plant Key & Symbols

**A) Muhlenbergia rigens**  
*Deer Grass* (3) 3'x4'

**B) Festuca idahoensis 'Siskiyou Blue'**  
*Siskiyou Blue Fescue* (6) 2'x1'

**C) Armeria maritima**  
*Sea Pinks* (3) 1'x1'

## Mulch and Rocks

- Birdseye (3/8") Pea Pebble
- Twin Oaks Boulders
- Autumn Flame Flag Step Stones

## Care and Maintenance

### Water:

Year 1: 1x/week 7-10 minutes

Year 2+: 1x/1-2 weeks 7-10 minutes

### Light:

Full – half day sun

Trim grasses back every other year for a neat and clean appearance.

**Native grasses are a gorgeous addition to any native garden. Their texture, movement, and color create visual appeal and are perfect for breaking up large groups of perennials, lining paths, or as part of a meadow planting.**

**Used in a parking strip setting, native clumping grasses are virtually maintenance free, save water, and still allow movement through the area if needed. Taller varieties such as the Deer Grass shown here are also useful for obscuring utility boxes while still allowing easy access to the boxes when needed.**

**Native grasses are also attractive to smaller birds which use the seed for food and the leaves and stems for nesting materials.**